

A NEO 3 carton contains two loudspeakers (black or white) and two plastic wall-mount brackets.

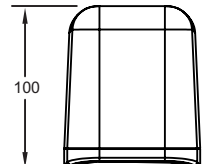

The impedance mode is selected by a rear slide switch (10W position for line, 8Ω for low impedance)

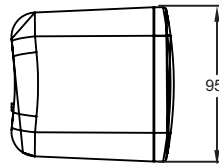
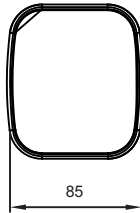
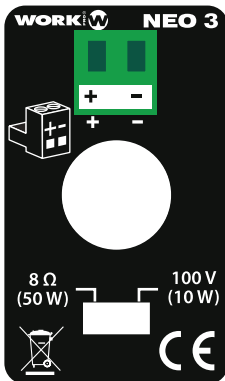

Make sure to select the 100V position before connecting the loudspeaker to a 70/100V line amplifier. If the low impedance position (8Ω) is selected, the loudspeaker could be damaged!

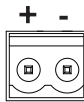
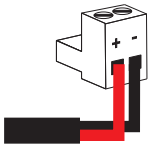

The connection is made through Euroblock terminals. Ensure the correct polarity is observed.

(*) Power Taps (70V).....	5W(980Ω)
Power Taps (100V).....	10W(1kΩ)
Power handling (8Ω) .....	50W RMS (with overload protection)
Sensitivity (1W/1m) .....	87 dB
Max. SPL (1m) .....	100 dB
Frequency Response .....	150Hz - 20kHz
Elements.....	2.5" Woofer
Dimensions .....	85 x 95 x 100 mm
Material (enclosure) .....	ABS plastic
IP rating .....	IP 54
RAL colour code .....	RAL 9003 (W) / RAL 9004 (B)
Material (grille) .....	Aluminium
Weight .....	0,5 Kg

(\*) The power rating indicated on the selector switch is calculated for 100V line. In the case of 70V line installation, the power rating is half the value.

Specifications are subject to change without notice

## Wall-mount bracket

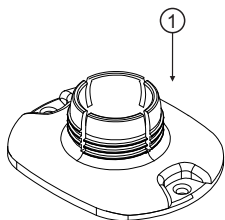

1	Rear wall mounting part
2	Threaded Ball
3	Locking nut
4	Fixation screw (x2)
5	Fixation nut

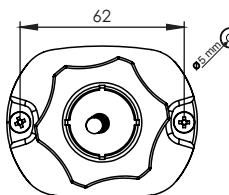
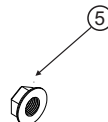
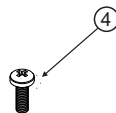
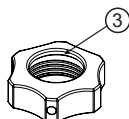
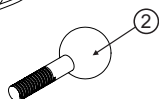

figure 1

Use the wall mounting part (1) to mark the fixing points on the wall. Take into account the dimensions between holes and the diameters marked in figure 1.

Drill wall and insert wall fixings. Screw wall mounting part to wall. Ensure that suitable screws and wall fixings are used. If in any doubt contact a suitably qualified expert.

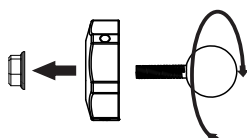

figure 2

Pass the threaded ball piece (2) through the locking nut (3) and screw it directly into the loudspeaker.

Tighten M6 nut (5) against the loudspeaker with a spanner. Do not over tighten.

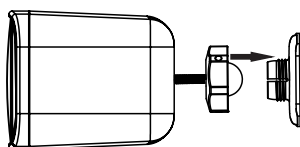

figure 3

Attach the complete set (loudspeaker+ threaded ball + locking nut) to the wall mounting part (1). See figure 3.

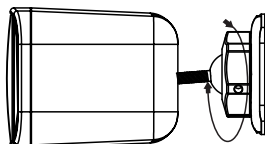
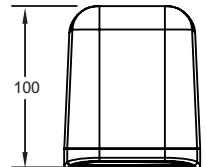
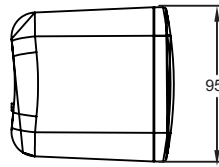
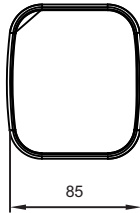
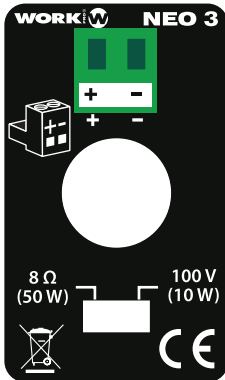

figure 4

Screw the locking nut (3) but not fully tight yet. See figure 4. Angle the loudspeaker to obtain the desired orientation. Once the angle is final, fully tighten the locking nut, but do not over tighten.

Un set de NEO 3 contiene dos altavoces (color blanco o negro) y 2 soportes de pared de plástico.



El tipo de conexión se selecciona mediante el conmutador deslizante ( posición de 10W para línea, 8Ω para baja impedancia)



Asegúrese de seleccionar la correcta posición de potencia antes de conectar el altavoz a un amplificador de línea 70/100V. Si se selecciona la posición de baja impedancia (8Ω), el altavoz puede dañarse.

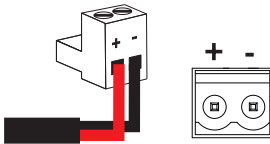

El conexionado se realiza mediante terminales Euroblock. Asegúrese de la correcta polaridad.

(*) Potencia (70V).....	5W(980Ω)
Potencia (100V).....	10W(1kΩ)
Potencia a baja impedancia .....	(8Ω) 50W RMS (con protecc. de sobrecarga).
Sensibilidad (1W/1m) .....	87 dB
Max. SPL .....	100 dB
Respuesta en Frecuencia .....	150Hz - 20kHz
Elementos.....	2.5" Woofer
Dimensiones .....	85 x 95 x 100 mm
Material (recinto) .....	Plástico ABS
Rango IP .....	IP 54
Código color RAL .....	RAL 9003 (W) / RAL 9004 (B)
Material (rejilla) .....	Aluminio
Peso .....	0,5 Kg

(\*) Las posición indicada en el selector está calculada para línea de 100V. En el caso de una instalación de línea 70V, la posición de potencia corresponderá a la mitad del valor.

Las especificaciones están sujetas a cambio sin previo aviso.

## SopORTE de pared

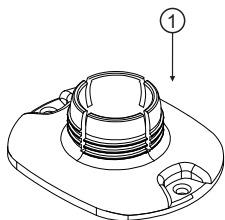

1	Pieza de fijación a la pared
2	Rótula
3	Tuerca de Bloqueo
4	Tornillo de fijación (x2)
5	Tuerca de fijación



figura 1

Use la pieza de montaje a la pared (1) para marcar los puntos de fijación. Tenga en cuenta las dimensiones entre agujeros y los diámetros marcados en la figura 1.

Realice los taladros e inserte los elementos de fijación.

Atornille el soporte a la pared. Asegúrese de utilizar los tornillos y fijaciones a la pared adecuados. En caso de duda, consulte con un experto.

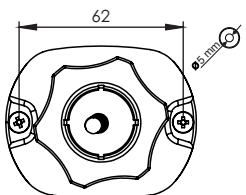
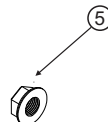
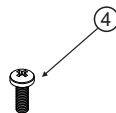
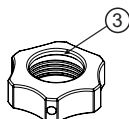
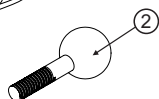

figura 2

Deslice la rótula (2) a través de la tuerca de bloqueo (3) y atornillela directamente sobre la caja acústica.

Apretar la tuerca M6 (5) contra el altavoz con una llave inglesa. No apriete demasiado.

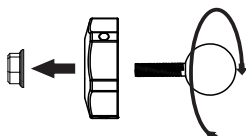

figura 3

Mueva el conjunto completo (caja acústica + rótula + tuerca de bloqueo) hacia la pieza de fijación de pared (1). Ver figura 3.

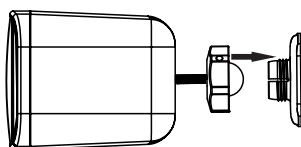
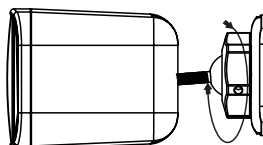

figura 4

Atornille la tuerca de bloqueo (3) hasta lograr una buena fijación. Durante este proceso, puede mover la caja acústica para obtener el ángulo de emisión deseado. Después de finalizar este proceso, puede apretar firmemente la tuerca de bloqueo. Ver figura 4.